

Collection of Stool for Ova and Parasites

CAUTION

The container contains a liquid preservative.

The preservative solution is poisonous. Keep out of reach of children.

Note:

DO NOT pour out any of the fluid in the container.

DO NOT overfill the container when adding stool sample.

Collect stool directly into the collection basin provided by the laboratory, following the instruction sheet: **Collecting a Stool Specimen for Laboratory Testing**. Do not contaminate sample with urine, toilet water or toilet paper as this may affect the test result.

1. Wash hands before collecting the sample.
2. Add 2 to 3 spoonfuls of stool (spoon on lid) to the container until the liquid reaches the "fill line". Choose a portion of the stool that contains mucous or blood, if present. Add stool within 30 minutes of sample collection.

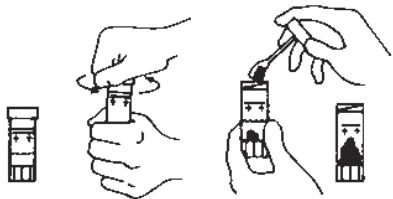

3. Replace the lid and tighten firmly. After replacing the lid, gently mix the container until the sample is well mixed with the liquid.



4. Wash hands after collection.
5. Label the container with your full legal first and last name, date of birth and BC Services Card/health care card number. Write the date and time of collection on the sample container.
6. Place your sample in a sealed plastic bag. Keep refrigerated until you return it to the lab. The sample must be delivered to the laboratory immediately after collection during open laboratory hours of operation. Testing is only valid for a limited time.

If you have any questions about your sample collection, please contact your local laboratory.

You must present your current health insurance (i.e. B.C. Services Card, provincial health insurance card) and requisition to the laboratory.

Call 8-1-1 Healthlink BC www.healthlinkbc.ca	Nurse	24 hours a day	Daily	Call 8-1-1 to speak with a nurse, ask a dietitian about nutrition, or a pharmacist about your medication.
	Dietitian	9 a.m. – 5 p.m.	Mon – Fri	
	Pharmacist	5 p.m. – 9 a.m.	Daily	
	Hearing Impaired	Call 7-1-1		