

# CSB 1<sup>st</sup> Floor

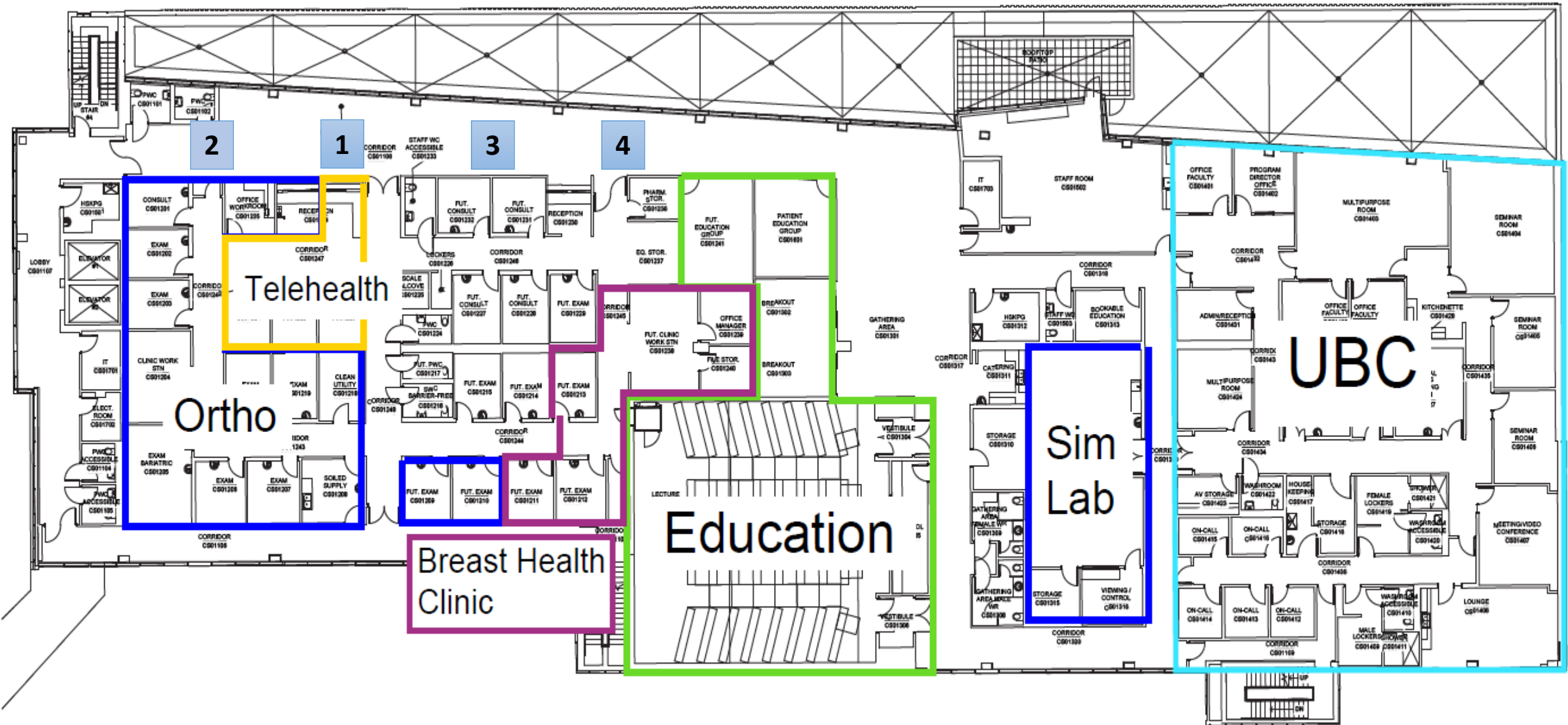

# CSB 1<sup>st</sup> Floor

1

**Telehealth** *(hours vary)*

2

**Ortho Clinic** *(7:30am to 4:00pm, M-F)*

3

**TRFO Maternity Clinic** *(8:30am to 4:00pm M-F)*

4

**Rae Fawcett Breast Health Clinic**

**Internal Med Clinic (RAMAC)** *(7:30am to 3:30pm M-F)*

# CSB 2<sup>nd</sup> Floor

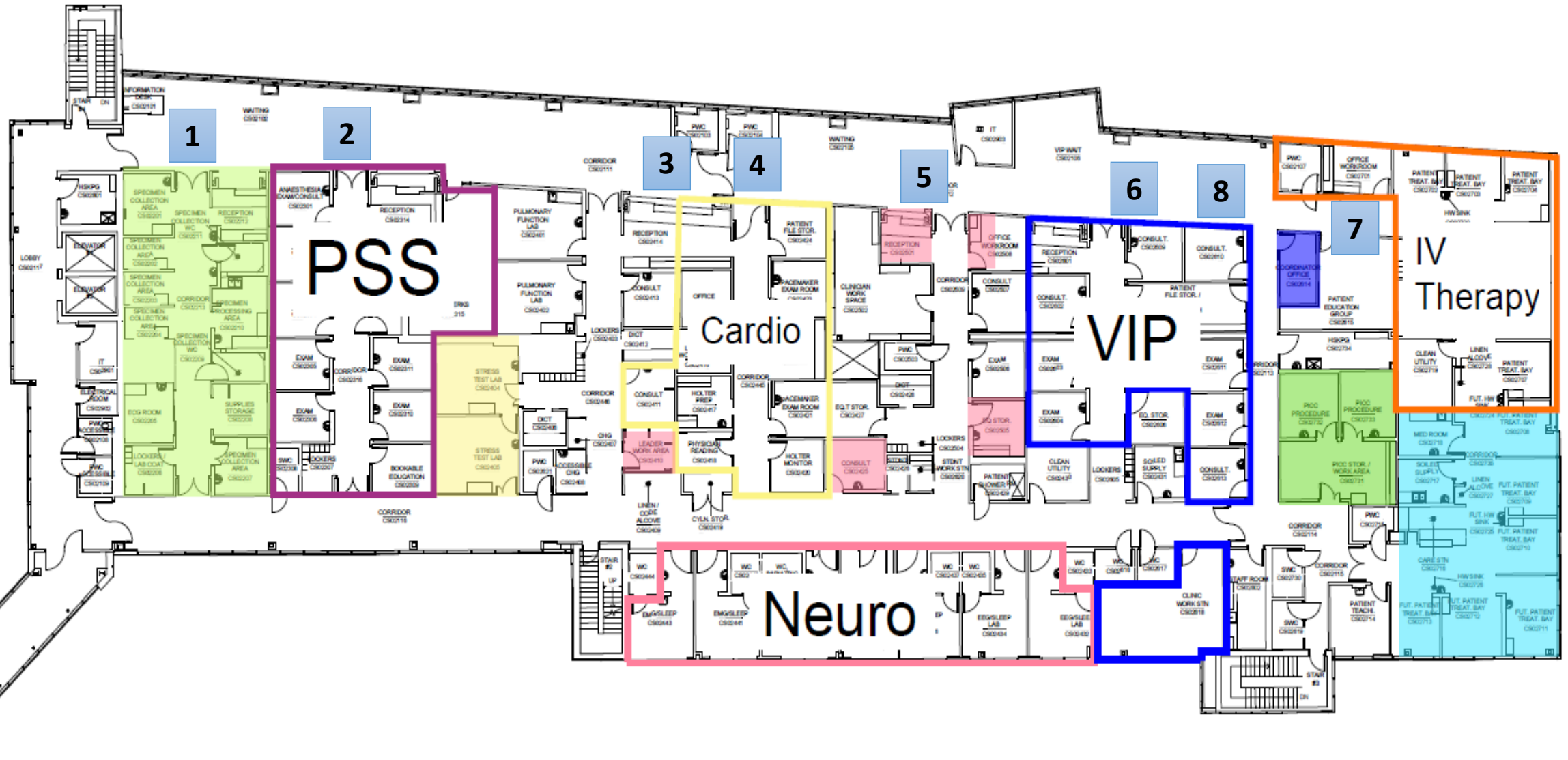

# CSB 2<sup>nd</sup> Floor

1

**Outpatient Lab** *(7:00am to 1:30pm, M-F Walk-ins and add-ons; 1:30pm to 5:00pm Clinical & Non-clinical; 9:00 to 11:00 Sat-Sun on-line booking; closed STATS)*

2

**Pre-Surgical Screening** *(7:00am to 5:00pm, M-F)*

3

**Rapid Access Clinic Cardiology** *(8:00am to 3:00pm, M-F)*

4

**Cardiology Outpatient** *(ECG 9:00am to 2:40pm) (Office 7:00am to 4:00pm)*

5

**Neurodiagnostics** *(8:00am – 4:00pm, M-F)*  
**Infectious Disease (ID) Clinic**

6

**Vascular Improvement Program (VIP)** *(8:00am to 4:00pm, M-F)*

7

**IV Therapy / PICC Clinic** *(7:45am to 3:30pm, M-F)*

8

**TIA / Stroke Clinic** *(8:00am to 4:00pm, M-F)*  
**Heart Function Program**